

PROPOSED STAGE 1 WORKS TO CONSIST  
OF EARTH WORKS: BULK EXCAVATION,  
LEVELLING BENCHING & RETAINING WALLS.

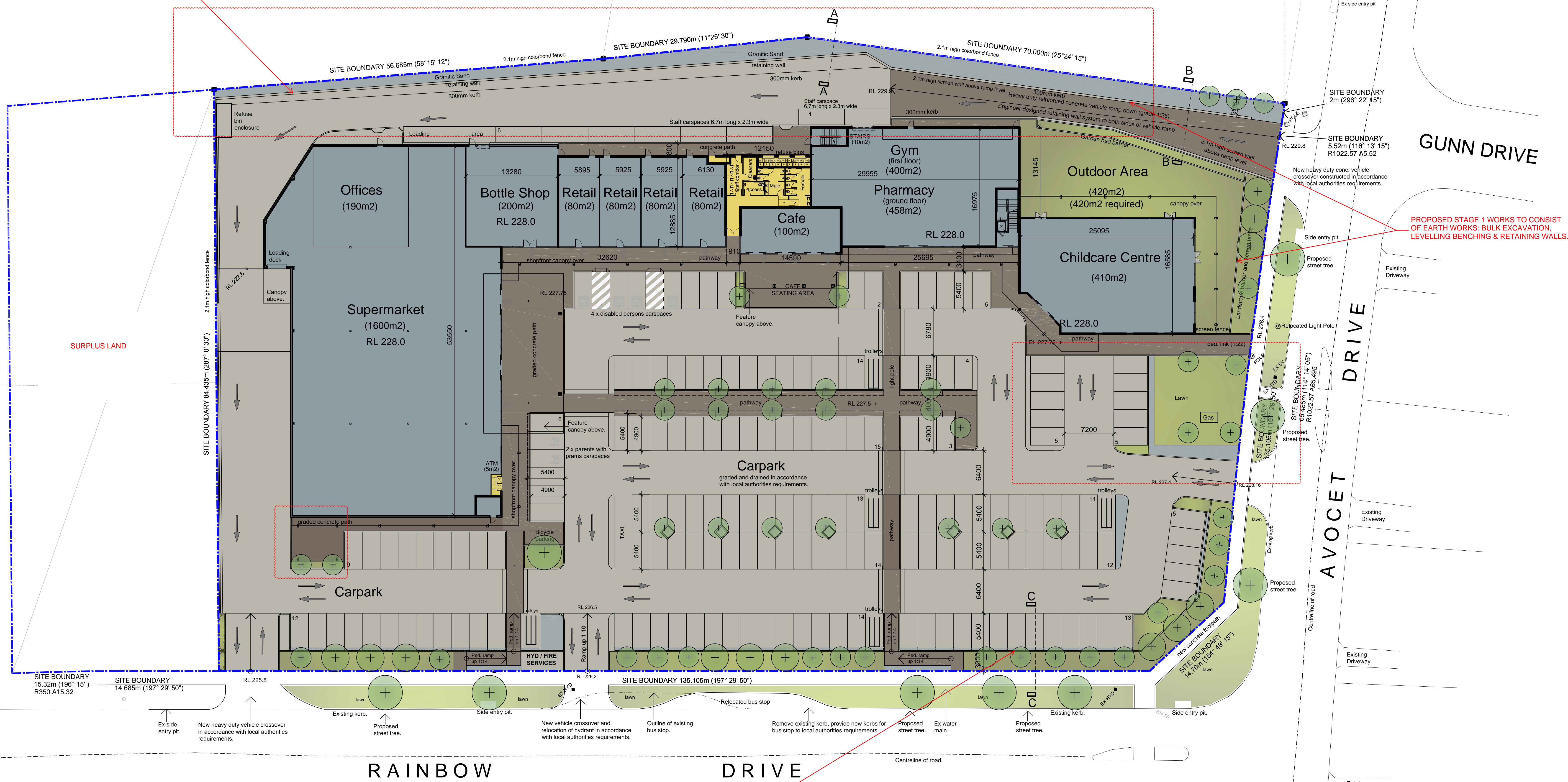

ALMA  
CRESCENT

RAINBOW

DRIVE

AVOCET  
DRIVE

GUNN DRIVE

## DEVELOPMENT SUMMARY

SITE	
Site area	13,100m <sup>2</sup>
BUILDING AREA	
Supermarket	1790m <sup>2</sup>
Bottle Shop	200m <sup>2</sup>
Retail shops	320m <sup>2</sup>
Cafe	100m <sup>2</sup>
Pharmacy	450m <sup>2</sup>
Gym (Incl Staircases & Lift)	440m <sup>2</sup>
ATM	8m <sup>2</sup>
Child care	410m <sup>2</sup>
Amenities(Incl. corridor)	100m <sup>2</sup>
Total building area	3818m <sup>2</sup>
CARSPACES	
Total required 5in 100(excl child care)	161
Total required child care (60 kids)	15
Total provided	176

REFER TO LANDSCAPE PLAN FOR  
ALL PLANTING & LANDSCAPING DETAILS

ALL EXTERNAL BUILDING & CAR PARK  
LIGHTING TO FUTURE DETAIL IN STRICT  
ACCORDANCE WITH THE RELEVANT  
AUSTRALIAN STANDARDS & AUTHORITY  
REQUIREMENTS. ALL LIGHTING WILL BE  
DESIGNED TO REDUCE GLARE AND BE  
BAFFLED TO MINIMIZE LIGHT SPILL

REV	DESCRIPTION	DATE
G	STAGING OF DEVELOPMENT APPROVAL CLASSIFIED (EARTHWORKS/RETAINING WALL & CONSTRUCTION OF DEVELOPMENT)	01/10/21
F	STAGE 1 DEVELOPMENT AREAS AMENDED: • PEDESTRIAN LINK LOCATION MOVED • LANDSCAPE STRUCTURE CREATED • LANDSCAPING AND TREES ADJUSTED • 3 CARPARKS REMOVED • TREES REMOVED ABOVE RETAINING WALL	ND 14.03.17
E	STAGE 1 DEVELOPMENT AREAS AMENDED: • PEDESTRIAN LINK LOCATION MOVED • 4 CARRIAGES TO CHILD CARE MOVED OVER • CARRIAGES FROM BUILDING DOWN • LANDSCAPING AND TREES ADJUSTED • TO SUIT • 4 CARPARKS AND SPEED HUMP DELETED	23.08.16
D	STAGE 1 DEVELOPMENT AREAS AMENDED: • MATERIALS ADDED • FEATURE WALLS IMPLEMENTED • FIRM LOCATIONS • ELEVATIONS UPDATED TO LATEST DESIGN	08.04.16
C	STAGE 1 DEVELOPMENT AREAS AMENDED: • RETAIL AREA INCREASED • CAFE AREA INCREASED • PHARMACY AREA INCREASED • INTRODUCED GYM (FIRST FLOOR) • INTRODUCED CHILDCARE • INTRODUCED FIRST FLOOR • ASSOCIATED AMENITIES • NORTH-EAST VEHICLE CROSSOVER • LOCATION OF PEDESTRIAN LINKS • INCREASED IN CAR PARKING	19.08.15
B	NORTHEAST ENTRY AMENDED	AR 10.03.15
A	TOWN PLANNING SUBMISSION	
REV	AMENDMENT DETAILS	BY DATE



concept +  
design + interiors +  
project management

Level 1, 1336-1338 Malvern Road  
Melbourne, Victoria 3144 Australia  
T: +61 3 9542 3300 F: +61 3 9542 9310  
www.trg-ae.com  
The Retail Group Pty Ltd ABN 85 050 134 686  
RBP No. DP-AD1689

BUILDER/CONTRACTOR TO VERIFY ALL DIMENSIONS ON SITE PRIOR  
TO PRODUCING SHOP DRAWINGS. ORDERING MATERIALS OR  
COMBINING WORK ON SITE. USE FIGURED DIMENSIONS ONLY. DO  
NOT SCALE DRAWINGS & INFORM US OF ANY CONFLICT OR  
DISCREPANCY BETWEEN SITE CONDITIONS AND DOCUMENTS.  
DRAWINGS SHALL BE READ IN CONJUNCTION WITH RELEVANT  
CONSULTANTS DRAWINGS, REGULATORY CODES AND STANDARDS.  
© COPYRIGHT 2014 BY  
COPYRIGHT OF DESIGNS SHOWN HEREIN IS RETAINED BY THIS  
OFFICE. WRITTEN AUTHORITY IS REQUIRED FOR ANY REPRODUCTION.

PROPOSED SUPERMARKET AND  
RETAIL DEVELOPMENT

PROJECT ADDRESS  
CNR RAINBOW & AVOCET DRIVE

ESTELLA  
NSW 2650

PROPOSED SITE PLAN  
STAGE 1

CLIENT  
ALLETTSA PTY LIMITED

DATE	SCALE	NORTH
SEP 14	1:250	
DRAWN MT/LK	CHECKED IW	
ISSUE TOWN PLANNING	DRAWING No. TP03.1	REVISION No. G
PROJECT No. 10157		SHEET 03 of 08